

# Ø30" GRADE RING ADJUSTMENTS

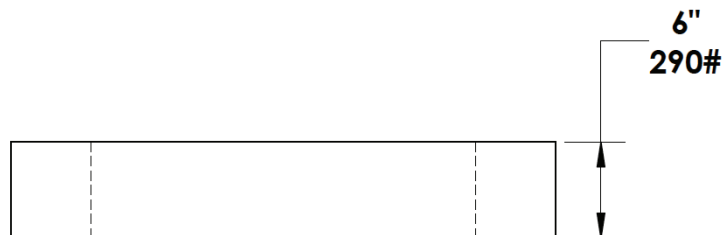

\* ROUND ADJUSTMENTS MEET  
OR EXCEED THE REQUIREMENTS  
OF ASTM C478/AASSTO M199,  
ASTM C443, & ASTM C890.

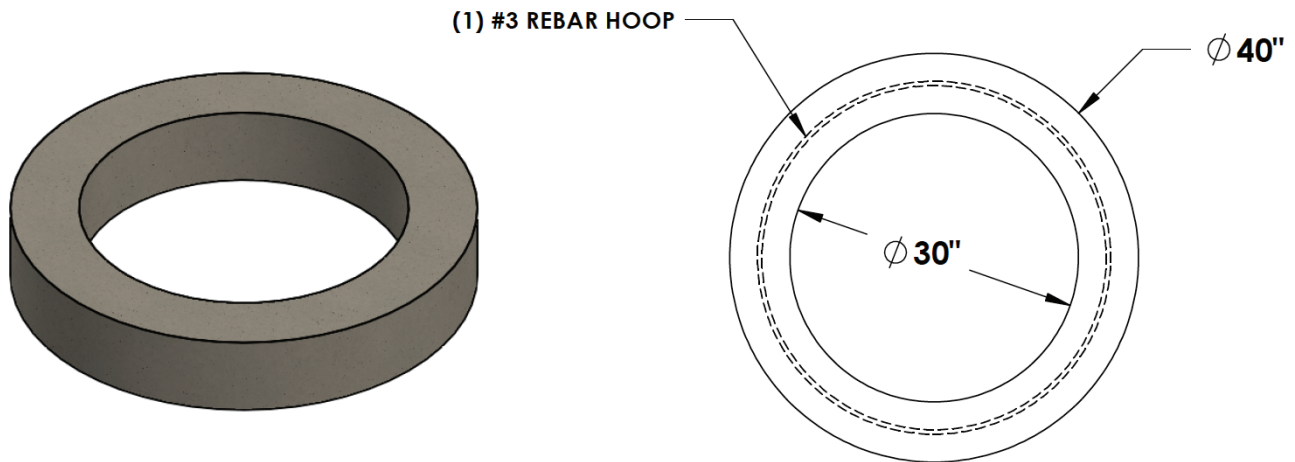

# INLAND NORTHWEST PRECAST

5516 NORTH STARR RD PO BOX 610, NEWMAN LAKE, WA 99025 ~ (509) 226-5050